

## **INSTALLATION INSTRUCTION**

Model: VT-4735  
LED Tracklight



## **INTRODUCTION**

Thank you for selecting and buying V-TAC LED Track light. V-TAC will serve you the best. Please read these instructions carefully before starting the installation and keep this manual handy for future reference. If you have any other query, please contact our dealer or local vendor from whom you have purchased the product. They are trained and ready to serve you at the best.

---

## TECHNICAL PARAMETERS

Performace parameter	Lamp	warm white	natural white	cool white
	Lumens (lm)	2600 lm	2700 lm	2800 lm
	Color temperature (K)	3000K	4000K	6400K
	CRI	≥80		
	Type of LED	COB LED		
	Beam angle	15 - 16°		
	Decay rate (%)	less than 3% within 1000 working hours		
	Total power (W)	35W		
	Lifespan (Hrs)	≥30000Hrs		
	High voltage testing	1750Vac/1min		
LED parameter	Lighting efficiency	100LM/W		
	Chip quantity	72PCS		
	Series-parallel way	12C6B		
	Voltage	36 - 39V		
	Current	850mA		
Driver specification	Input parameter	220~240Vac, 50/60Hz		
	Power factor	0.9		
	Output paremeter	850mA, 30-48V		
Structure parameter	Material	Aluminum		
	Dimension	197.7 x 178.4 x 95mm		
	Cut - out	/		
	Protection class	calss I		
	IP	IP20		
Environment parameter	Application	hotel, home-lighting, recreation place, supermarket office building		
	Operating temperature	-25°C ~ 50°C, 10% - 90% R.H.		
	Storage temperature	-30°C ~ 85°C, 0% - 95% R.H.		
Packing specification	Qty / Ctn	carton size	N.W	G.W

## STRUCTURE & SIZE

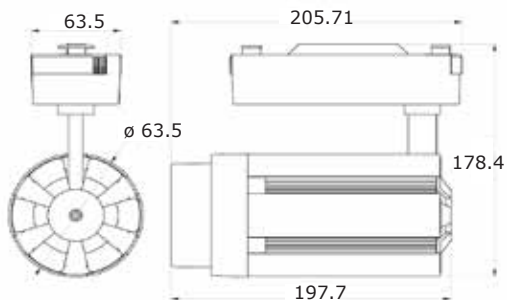
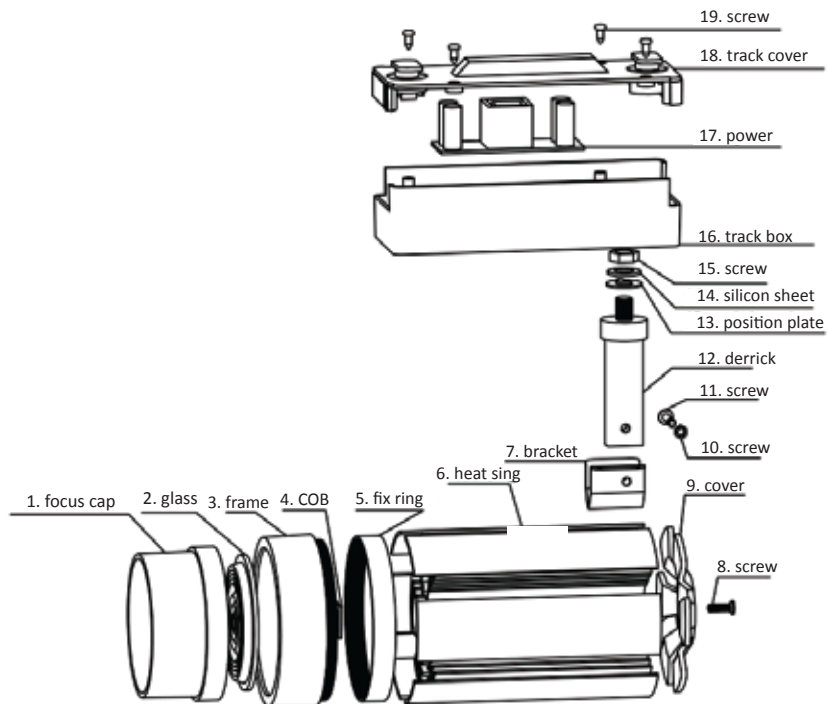

## **INSTALLATION INSTRUCTION**

1. Switch off the power.
2. Install track in the ceiling solidly.
3. Connect the electricity 110-220V. (picture 1)
4. Turn adaptor slide switch. (picture 2)
5. Fix the lamp into track, lift up the lamp and turn adaptor slide switch. (picture 3)
6. Switch on the power if above steps done properly without any mistakes.

